

AQUADRIVE ENGINE MOUNTS

The Aquadrive system creates free movement between the engine and the propeller shaft. One result is the engine's mountings can be much softer than normal, partly because the engine can vibrate freely relative to the shaft, and partly because no propeller thrust reaches the mounts and strains them forwards. Aquadrive engine mounts can be used with almost any marine engine, and our expert staff will rapidly select the correct rubber stiffness for the machinery involved.

50210

The smallest engine mount of the range is available in four rubber grades for weights up to 60 kg per mount.

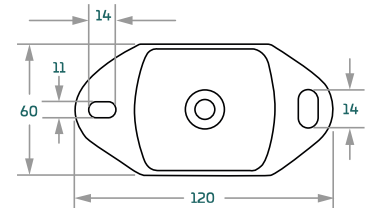
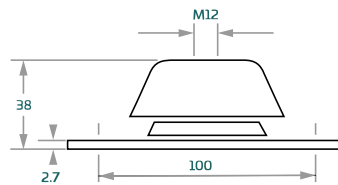

50220

The most versatile mount is available in five different rubber grades and takes weights up to 200 kg per mount.

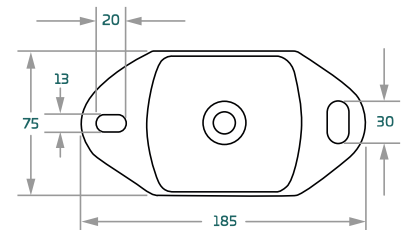
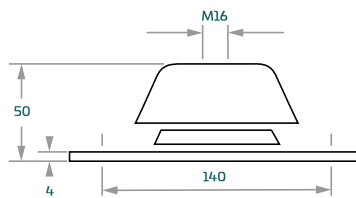

50230

This engine mount is available in four different rubber grades and will take weights up to 800 kg per mount.

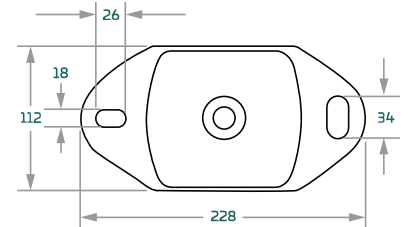
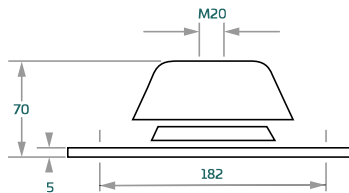

50240

The largest of engine mount of the range is available in four rubber grades taking up to 3000 kg per mount.

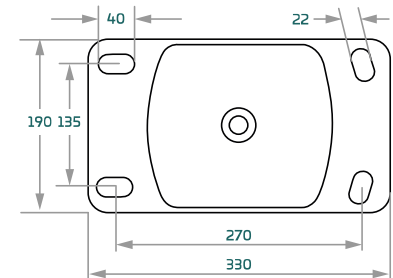
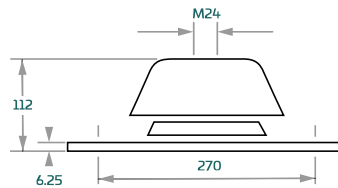

Engine mount deflection chart

Selecting the correct rubber grade and mount for a particular engine or generator is a skilled task and our expert staff will advise. For those who wish to study the science, the chart above shows how much deflection will occur on each mount and rubber hardness given a particular weight on the mount. In general you should aim for 3 mm on the 50210, 4 mm on the 50220, 5 mm on the 50230 and 6 mm on the 50240.

- 50210 ■ 50230
- 50220 ■ 50240

