

Heavy Duty Line HDL

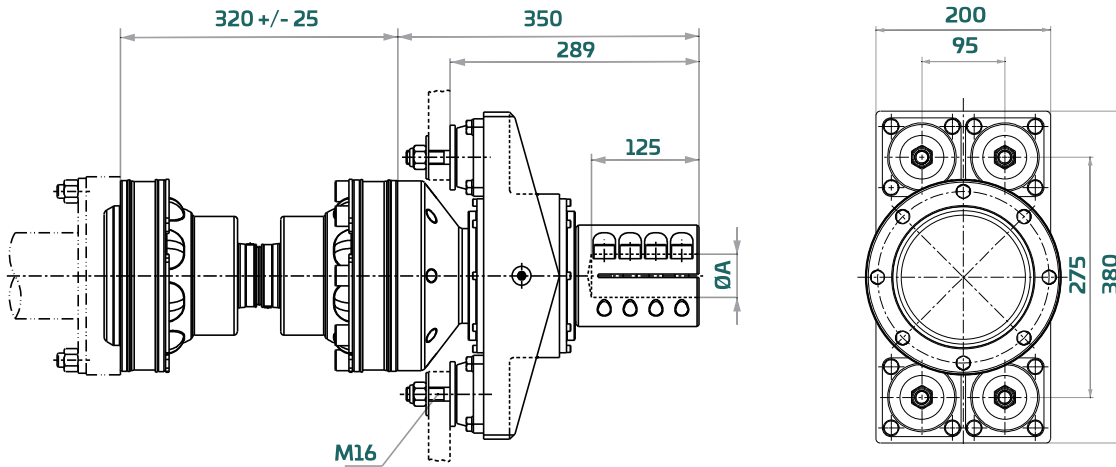

HDL 48.690

Max. static torque	12240 Nm / 9060 lbft
Max. propeller shaft revolutions	1700 rpm
Max. propeller thrust	40 kN / 9000 lbf



CV 48

Custom-length CV 48 driveshaft is available in lengths from 320 mm (from 420 mm with tubeshaft design). Maximum length depends on shaft rpm.

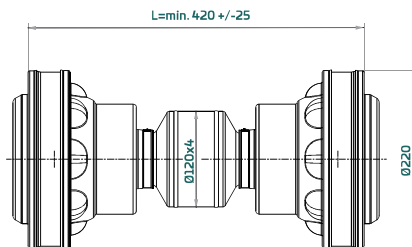

Application examples

	Rated power kw (HP)	Crankshaft rpm	Gearbox ratio
Displacement boat	410 (550)	2100	3 : 1
Planing boat	670 (900)	2800	2 : 1

Note: Above rating examples are based on optimum conditions with 2° for each CV joints. In case a CV joint will run at an angle greater than 2°, the max. permitted power must be reduced (normally by 8-9% for each degree over 2°). The maximum allowable joint angle is 5-8° depending on shaft rpm.

Propeller shaft options

HDL 680 standard version accepts following propeller shaft sizes:

50 mm	2"	2 ¼"	60 mm	2 ½"	65 mm	70 mm
-------	----	------	-------	------	-------	-------

Please contact our technical department to assist you in selecting a suitable Aquadrive system for your application.

Heavy Duty Line HDL

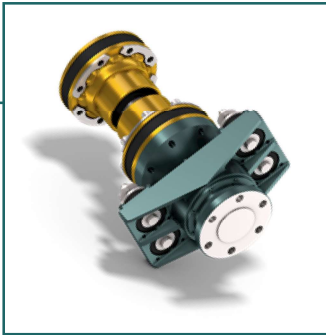

HDL 48.690 Flanged

Max. static torque	12240 Nm / 9060 lbft
Max. propeller shaft revolutions	1700 rpm
Max. propeller thrust	40 kN / 9000 lbf

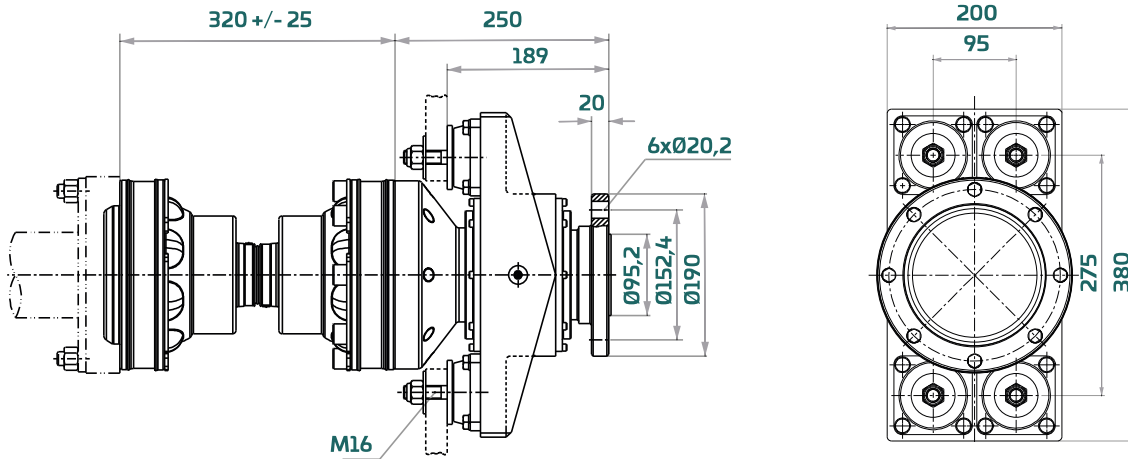

CV 48

Custom-length CV 48 driveshaft is available in lengths from 320 mm (from 420 mm with tubeshaft design). Maximum length depends on shaft rpm.

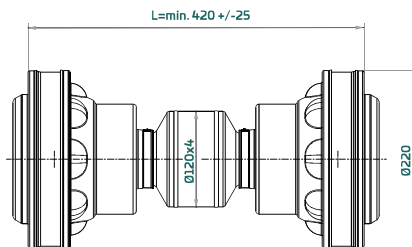

Application examples

	Rated power kw (HP)	Crankshaft rpm	Gearbox ratio
Displacement boat	410 (550)	2100	3 : 1
Planing boat	670 (900)	2800	2 : 1

Note: Above rating examples are based on optimum conditions with 2° for each CV joints. In case a CV joint will run at an angle greater than 2°, the max. permitted power must be reduced (normally by 8-9% for each degree over 2°). The maximum allowable joint angle is 5-8° depending on shaft rpm.

Propeller shaft options

HDL 680 standard version accepts following propeller shaft sizes:

50 mm	2"	2 ¼"	60 mm	2 ½"	65 mm	70 mm
-------	----	------	-------	------	-------	-------

Please contact our technical department to assist you in selecting a suitable Aquadrive system for your application.